



Telergon kapslede afbrydere

AC DC



CIS25 - A - C - D - F Enclosed switch - disconnecter IP65 (with or without fuse holders) 3P - 3P+N

Size 1

A 200|250|315



series
CIS25

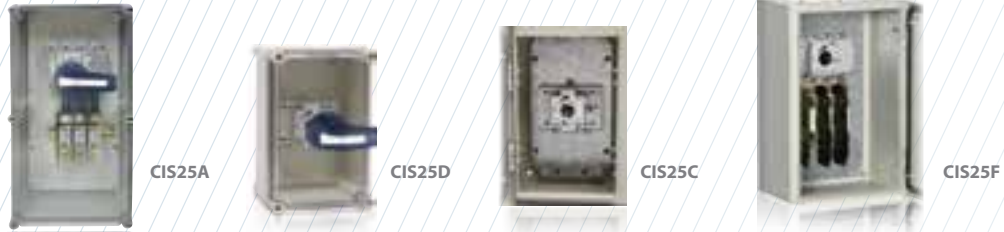

Enclosure	Model	Code	200	250	315
polyester enclosure + fuse holders	CIS25A 3P	CODE-200A	CIS25A02003PR	CIS25A02503PR	CIS25A03153PR
			CIS25A02003NR	CIS25A02503NR	CIS25A03153NR
polyester enclosure	CIS25D 3P	CODE-250A	CIS25D02003PR	CIS25D02503PR	CIS25D03153PR
			CIS25D02003NR	CIS25D02503NR	CIS25D03153NR
metal enclosure	CIS25C 3P		CIS25C02003PS	CIS25C02503PR	CIS25C03153PR
			CIS25C02003NS	CIS25C02503NR	CIS25C03153NR
metal enclosure + fuse holders	CIS25F 3P		CIS25F02003PR	CIS25F02503PR	CIS25F03153PR
			CIS25F02003NR	CIS25F02503NR	CIS25F03153NR

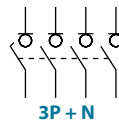
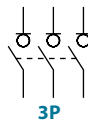

Technical information



According to IEC/EN 60947-3
IEC/EN 61439-1

		200 250 315		
Rated thermal current in ambient at	I _{the}	40 °C	A	200 250 315
Rated insulation voltage	U _i	V	1000	1000 1000
Rated dielectric strength	50 Hz., 1 min.	V	5000	5000 5000
Rated impulse withstand voltage	U _{imp}	kV	8	8 8
AC rated operational current ^{*(1)} (Rated operational frequency 50 / 60 Hz)	I _e	U _e 400V AC21A	A	200 250 315
		U _e 400V AC22A	A	200 250 315
		U _e 400V AC23A	A	200 250 315
		U _e 500V AC21A	A	200 250 315
		U _e 500V AC22A	A	200 250 315
		U _e 500V AC23A	A	160 200 250
AC rated operational power ^{*(2)}	P _e	3x400V AC23A	kW	110,8 138,5 174,5
Rated capacitor power		400V, sen φ = 0,65	kVAr	90 112,5 141,8
Rated breaking capacity		400V AC23A	A	1600 2000 2520
Rated making capacity		400V AC23A	A	2000 2500 3150

		200 250 315		
Short - circuit behaviour				
Rated short-circuit making capacity ^{*(3)}	I _{cm}	kA (peak)	20	20 20
Rated short-time withstand current (1sec.)	I _{cw}	kA rms	12	12 12
Conditional short - circuit current (rms value) ^{*(4)}		kA rms	100	100 100
Maximum cut - off current (peak value)		kA (peak)	33	33 33
Maximum power dissipation (I ² t)		A ² s (x10 ³)	497	1000 1000
Mechanical features				
Minimum number of mechanical operations ^{*(5)}		Cycles	20000	20000 20000
Maximum weight 3P		Kg		Consult
Maximum weight 3P + N		Kg		Consult

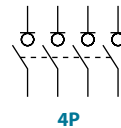

Also available 4P switches under request, consult reference

^{*(1)} Other voltages and / or utilization categories. Please consult
^{*(2)} Indicative values: current values vary from one motor manufacturer to another
^{*(3)} Without limiting protective device (short-circuit maintained 50... 100 ms.)
^{*(4)} With a protective device limiting the cut - off current and the joule integral to the indicated values
^{*(5)} Please consult us for more operations

Accessories



» External handle included

IP65 | UL50E/NEMA 250
Types: 1, 3R, 4, 4X y 12



» Emergency external handle under request

IP65 | UL50E/NEMA 250
Types: 1, 3R, 4, 4X y 12



» Auxiliary contacts

1NO+1NC CODE D5LAU01
2NO+2NC CODE D5LAU02

Ie = 16 A (resistive loads)
4 A (inductive loads) at 250 Vac.



» Terminal protection

CODE DR-CU11
(1 kit for input or output)



» Safety key lock device

Simple CODE DS-CA11
Double CODE DS-CE11

For external handle, lock the handle by means of a key in position "OFF" (under request, in "ON"), the key can only be removed with the handle locked

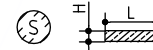
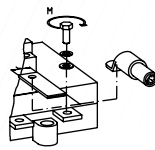

	S max (Cu) mm ²	H max (Cu) mm	L max (Cu) mm	T	M
200 A				M8	13
250 A	185	7	25	M10	18
315 A					

Dimensions (mm)

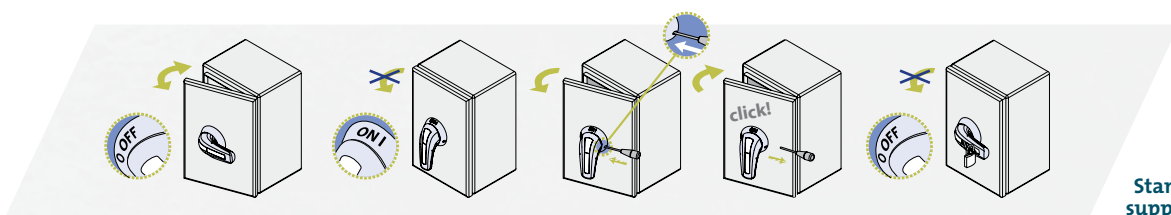
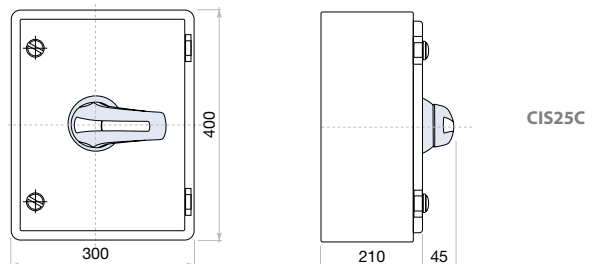
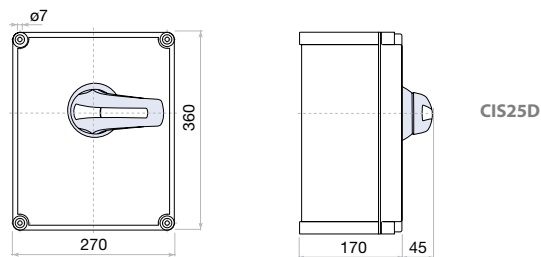
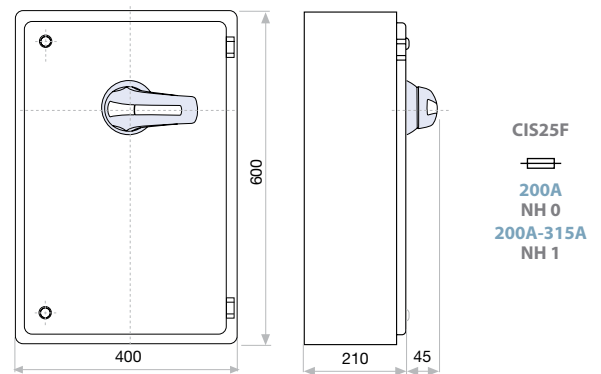
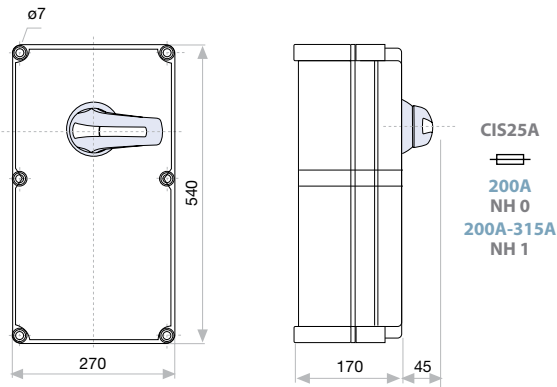

CIS25 - A - C - D - F Enclosed switch - disconnecter IP65 (with or without fuse holders) 3P - 3P+N

Size 2

A 400|630



series
CIS25

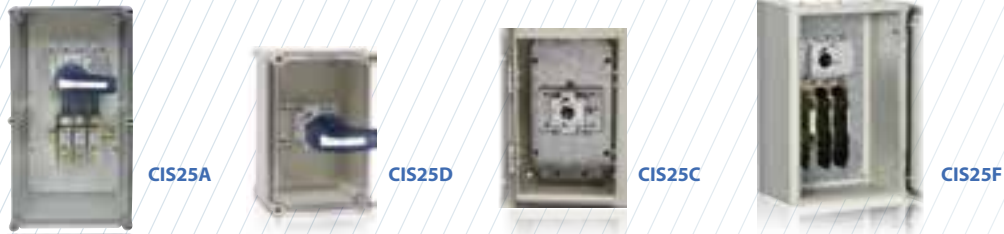

Enclosure	Model	Poles	CODE - 400A		CODE - 630A	
			PR	NR	PR	NR
polyester enclosure + fuse holders	CIS25A	3P	CIS25A04003PR	CIS25A04003NR	CIS25A06303PR	CIS25A06303NR
		3P + N				
polyester enclosure	CIS25D	3P	CIS25D04003PR	CIS25D04003NR	CIS25D06303PR	CIS25D06303NR
		3P + N				
metal enclosure	CIS25C	3P	CIS25C04003PC	CIS25C04003NC	CIS25C06303PR	CIS25C06303NR
		3P + N				
metal enclosure + fuse holders	CIS25F	3P	CIS25F04003PR	CIS25F04003NR	CIS25F06303PR	CIS25F06303NR
		3P + N				

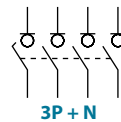
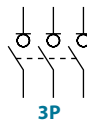

Technical information



According to IEC/EN 60947-3
IEC/EN 61439-1

		400		630	
Rated thermal current in ambient at	I _{the}	40 °C	A	400	630
Rated insulation voltage	U _i		V	1000	1000
Rated dielectric strength	50 Hz., 1 min.		V	5000	8000
Rated impulse withstand voltage	U _{imp}		kV	8	12
AC rated operational current ^{*(1)} (Rated operational frequency 50 / 60 Hz)	I _e	U _e 400V AC21A	A	400	630
		U _e 400V AC22A	A	400	630
		U _e 400V AC23A	A	400	630
		U _e 500V AC21A	A	400	630
		U _e 500V AC22A	A	400	630
		U _e 500V AC23A	A	400	500
AC rated operational power ^{*(2)}	P _e	3x400V AC23A	kW	221,7	349,1
Rated capacitor power	400V, sen φ = 0,65	kVAr		180,1	283,7
Rated breaking capacity	400V AC23A	A		3200	5000
Rated making capacity	400V AC23A	A		4000	6300

		400		630	
Short - circuit behaviour					
Rated short-circuit making capacity ^{*(3)}	I _{cm}	kA (peak)	20	26	
Rated short-time withstand current (1sec.)	I _{cw}	kA rms	12	16	
Conditional short - circuit current (rms value) ^{*(4)}		kA rms	100	100	
Maximum cut - off current (peak value)		kA (peak)	33	39	
Maximum power dissipation (I ² t)		A ² s (x10 ³)	1000	1600	
Mechanical features					
Minimum number of mechanical operations ^{*(5)}		Cycles	20000	10000	
Maximum weight 3P		Kg	Consult		
Maximum weight 3P + N		Kg	Consult		

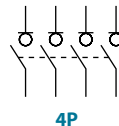

Also available 4P switches under request, consult reference

^{*(1)} Other voltages and / or utilization categories. Please consult
^{*(2)} Indicative values: current values vary from one motor manufacturer to another
^{*(3)} Without limiting protective device (short-circuit maintained 50... 100 ms.)
^{*(4)} With a protective device limiting the cut - off current and the joule integral to the indicated values
^{*(5)} Please consult us for more operations

Accessories



» External handle included
 IP65 | UL50E/NEMA 250
 Types: 1, 3R, 4, 4X y 12



» Emergency external handle under request
 IP65 | UL50E/NEMA 250
 Types: 1, 3R, 4, 4X y 12



» Auxiliary contacts
 1NO+1NC CODE D5LAU01
 2NO+2NC CODE D5LAU02
 Ie = 16 A (resistive loads)
 4 A (inductive loads) at 250 Vac.



» Terminal protection
 CODE DR-CU21
 (1 kit for input or output)



» Safety key lock device
 Simple CODE DS-CB21
 Double CODE DS-CF21

For external handle, lock the handle by means of a key in position "OFF" (under request, in "ON"), the key can only be removed with the handle locked

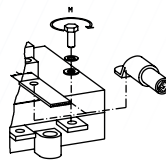

	S max (Cu) mm ²	H max (Cu) mm	L max (Cu) mm	M
400 A	2x185	6	40	M10 24
630 A	2x240	2x5	40	

Dimensions (mm)

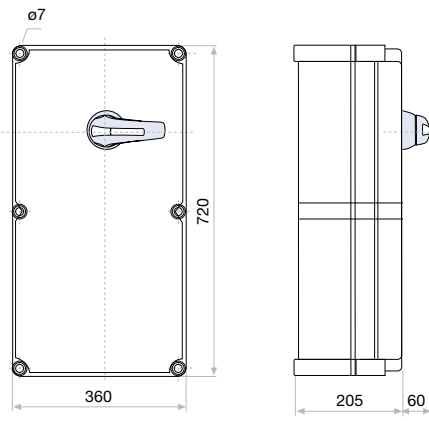

CIS25A
 400A NH 2
 630A NH 3

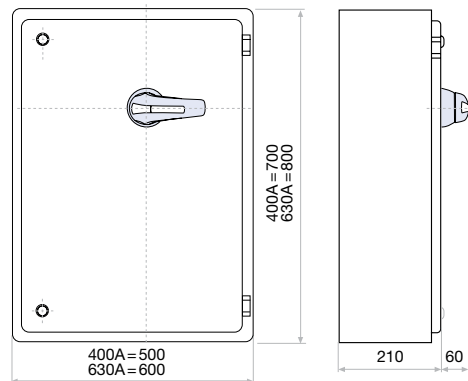

CIS25F
 400A NH 2
 630A NH 3

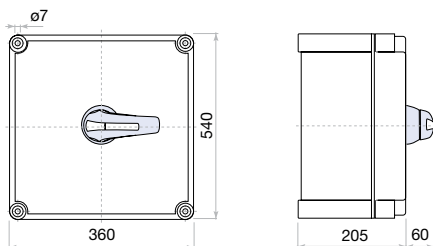

CIS25D

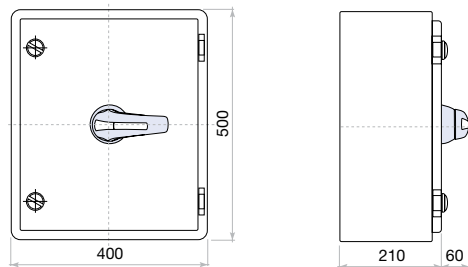

CIS25C

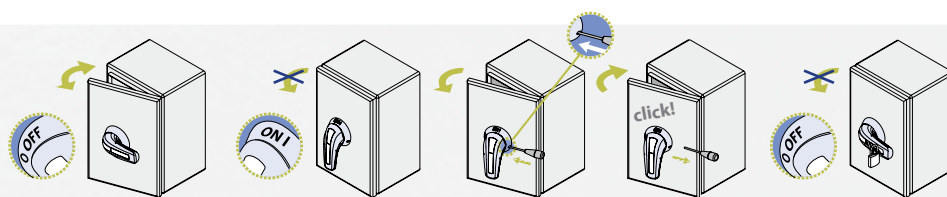

Standard supply

CIS25 - A - C - D - F

Enclosed switch - disconnecter

IP65 (with or without fuse holders) 3P - 3P+N

Size 3

A 800



series
CIS25

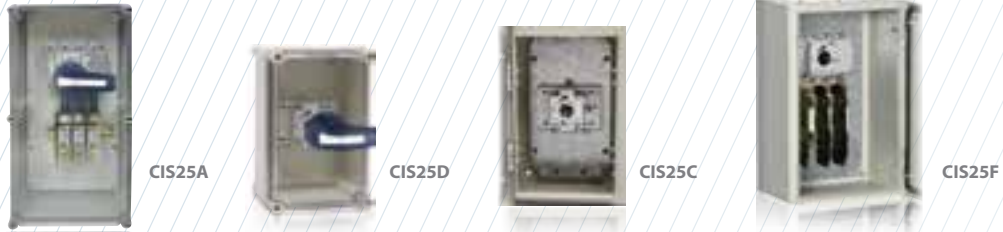

Enclosure Type	Model	Configuration	Code - 800A
polyester enclosure + fuse holders	CIS25A	3P	CIS25A08003PR
		3P + N	CIS25A08003NR
polyester enclosure	CIS25D	3P	CIS25D08003PR
		3P + N	CIS25D08003NR
metal enclosure	CIS25C	3P	CIS25C08003PR
		3P + N	CIS25C08003NR
metal enclosure + fuse holders	CIS25F	3P	CIS25F08003PR
		3P + N	CIS25F08003NR

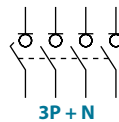
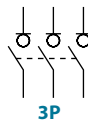

Technical information



According to IEC/EN 60947-3
IEC/EN 61439-1

		800		
Rated thermal current in ambient at	l _{the}	40 °C	A	800
Rated insulation voltage	U _i		V	1000
Rated dielectric strength	50 Hz, 1 min.		V	8000
Rated impulse withstand voltage	U _{imp}		kV	12
AC rated operational current ^{*(1)} (Rated operational frequency 50/60 Hz)	I _e	U _e 400V AC21A	A	800
		U _e 400V AC22A	A	800
		U _e 400V AC23A	A	800
		U _e 500V AC21A	A	800
		U _e 500V AC22A	A	800
		U _e 500V AC23A	A	800
AC rated operational power ^{*(2)}	P _e	3x400V AC23A	kW	443,4
Rated capacitor power		400V, sen φ = 0,65	kVAr	360,2
Rated breaking capacity		400V AC23A	A	6400
Rated making capacity		400V AC23A	A	8000

		800	
Short - circuit behaviour			
Rated short-circuit making capacity ^{*(3)}	I _{cm}	kA (peak)	60
Rated short-time withstand current (1sec.)	I _{cw}	kA rms	25
Conditional short - circuit current (rms value) ^{*(4)}		kA rms	72
Maximum cut - off current (peak value)		kA (peak)	55
Maximum power dissipation (I ² t)		A ² s (x10 ³)	4900
Mechanical features			
Minimum number of mechanical operations ^{*(5)}		Cycles	10000
Maximum weight 3P		Kg	Consult
Maximum weight 3P + N		Kg	Consult

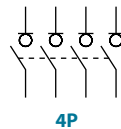

Also available 4P switches under request, consult reference

^{*(1)} Other voltages and / or utilization categories. Please consult
^{*(2)} Indicative values: current values vary from one motor manufacturer to another
^{*(3)} Without limiting protective device (short-circuit maintained 50... 100 ms.)
^{*(4)} With a protective device limiting the cut - off current and the joule integral to the indicated values
^{*(5)} Please consult us for more operations

Accessories



» External handle included
 IP65 | UL50E/NEMA 250
 Types: 1, 3R, 4, 4X y 12



» Emergency external handle under request
 IP65 | UL50E/NEMA 250
 Types: 1, 3R, 4, 4X y 12



» Auxiliary contacts
 1NO+1NC CODE D5LAU01
 2NO+2NC CODE D5LAU02
 Ie = 16 A (resistive loads)
 4 A (inductive loads) at 250 Vac.



» Terminal protection
 CODE DR-CU31
 (1 kit for input or output)



» Safety key lock device
 Simple CODE DS-CB31
 Double CODE DS-CF31

For external handle, lock the handle by means of a key in position "OFF" (under request, in "ON"), the key can only be removed with the handle locked

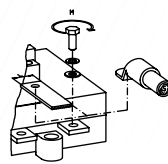

S max (Cu) mm ²	H max (Cu) mm	L max (Cu) mm	M	M
2x240	2x10	50	M14	45

Dimensions (mm)

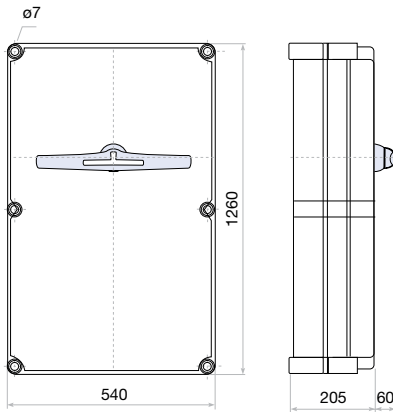

CIS25A
 NH 4

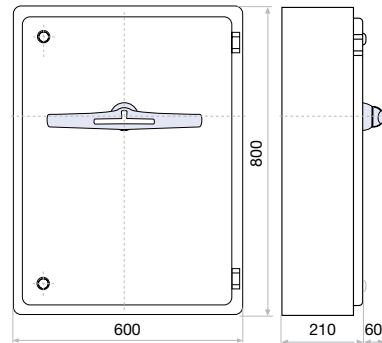

CIS25F
 NH 4

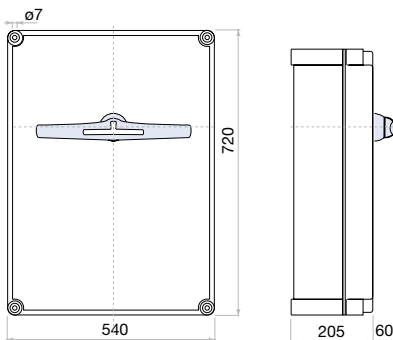

CIS25D

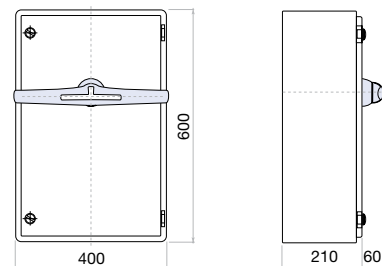

CIS25C

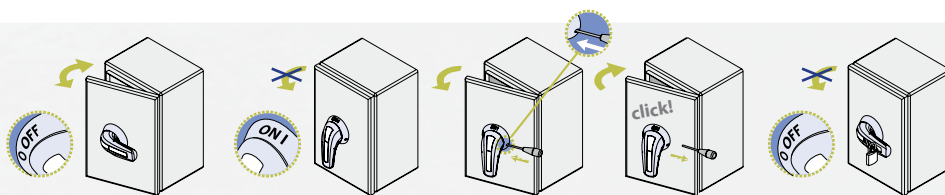

Standard supply

CIS25 - A - C - D - F

Enclosed switch - disconnecter

IP65 (with or without fuse holders) 3P - 3P+N

Size 4

A 1000|1250|1600



series
CIS25



CIS25A



CIS25D



CIS25C



CIS25F

			CODE - 1000A	CODE - 1250A	CODE - 1600A
polyester enclosure + fuse holders	CIS25A	3P	CIS25A10003PS	CIS25A12503PS	CIS25A16003PS
		3P + N	CIS25A10003NS	CIS25A12503NS	CIS25A16003NS
polyester enclosure	CIS25D	3P	CIS25D10003PS	CIS25D12503PS	CIS25D16003PS
		3P + N	CIS25D10003NS	CIS25D12503NS	CIS25D16003NS
metal enclosure	CIS25C	3P	CIS25C10003PS	CIS25C12503PS	CIS25C16003PS
		3P + N	CIS25C10003NS	CIS25C12503NS	CIS25C16003NS
metal enclosure + fuse holders	CIS25F	3P	CIS25F10003PS	CIS25F12503PS	CIS25F16003PS
		3P + N	CIS25F10003NS	CIS25F12503NS	CIS25F16003NS

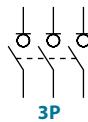

3P

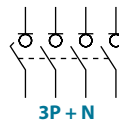

3P + N

Technical information



According to IEC/EN 60947-3
IEC/EN 61439-1

				1000	1250	1600	
Rated thermal current in ambient at	I _{the}	40 °C	A	1000	1250	1600	
Rated insulation voltage	U _i		V	1000	1000	1000	
Rated dielectric strength	50 Hz., 1 min.		V	10000	10000	10000	
Rated impulse withstand voltage	U _{imp}		kV	12	12	12	
AC rated operational current ^{*(1)} I _e (Rated operational frequency 50/60 Hz)	Ue	400V	AC21A	A	1000	1250	1600
		400V	AC22A	A	1000	1250	1600
		400V	AC23A	A	1000	1000	1000
		500V	AC21A	A	1000	1250	1600
		500V	AC22A	A	1000	1000	1250
		500V	AC23A	A	800	800	900

					1000	1250	1600
AC rated operational power ^{*(2)}	P _e	3x400V	AC23A	kW	554,2	554,2	554,2
Rated capacitor power		400V, sen φ = 0,65		kVar	450,3	450,3	450,3
Rated breaking capacity		400V	AC23A	A	8000	8000	8000
Rated making capacity		400V	AC23A	A	10000	10000	10000
Short - circuit behaviour							
Rated short-circuit making capacity ^{*(3)}	I _{cm}			kA (peak)	60	60	75
Rated short-time withstand current (1sec.)	I _{cw}			kA rms	25	25	50
Mechanical features							
Minimum number of mechanical operations ^{*(4)}				Cycles	10000	10000	4500
Maximum weight 3P				Kg	Consult		
Maximum weight 3P + N				Kg	Consult		

^{*(1)} Other voltages and / or utilization categories. Please consult

^{*(2)} Indicative values: current values vary from one motor manufacturer to another

^{*(3)} Without limiting protective device (short-circuit maintained 50... 100 ms.)

^{*(4)} Please consult us for more operations

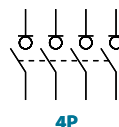

4P

Also available 4P switches under request, consult reference

Accessories



» External handle included

IP65 | UL50E/NEMA 250
Types: 1, 3R, 4, 4X y 12



» Emergency external handle under request

IP65 | UL50E/NEMA 250
Types: 1, 3R, 4, 4X y 12



» Auxiliary contacts

1NO+1NC CODE D5LAU01
2NO+2NC CODE D5LAU02

I_e = 16 A (resistive loads)
4 A (inductive loads) at 250 Vac.



» Terminal protection

CODE DR-CU41
(1 kit for input or output)



» Safety key lock device

Simple CODE DS-CB41
Double CODE DS-CF41

For external handle, lock the handle by means of a key in position "OFF" (under request, in "ON"), the key can only be removed with the handle locked

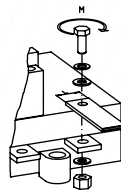

	H max (Cu) mm	L max (Cu) mm	T M	M Nxmm
1000 A				
1250 A	2x7	80	M16	80
1600 A			M14	55

Dimensions (mm)

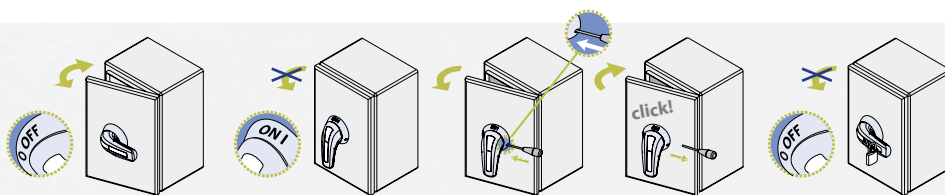
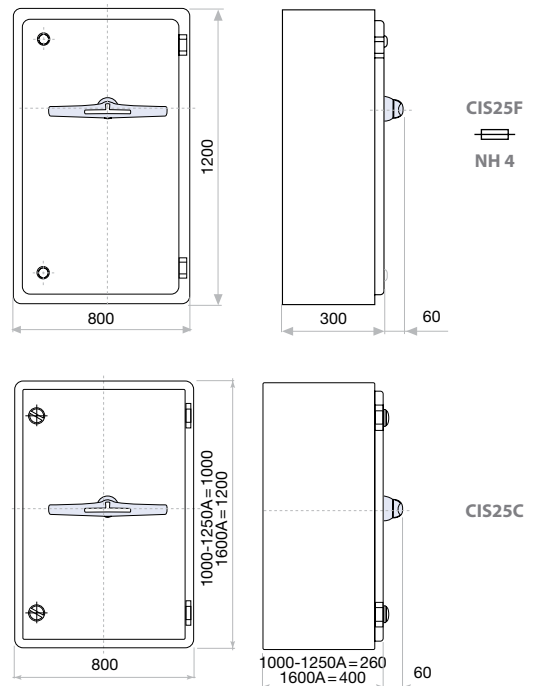
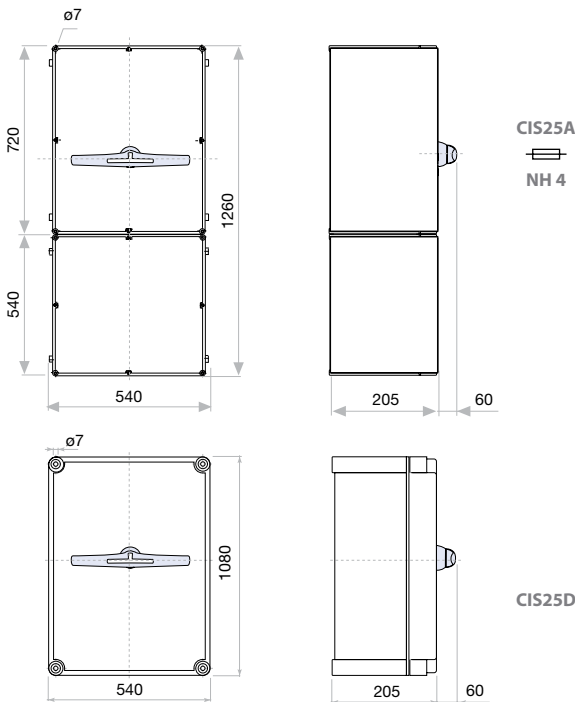

Standard supply