



ACCESSORIES CX

p. 36/37

ACCESSORIES FOR CABINET

p. 46/61

• MULTIPLE FAIRLEAD PLATE



• PARTITION BAFFLE



• SLIDE GUIDES



• SKIRTING



SELF-STANDING CABINETS WITH REMOVABLE SIDE PANELS SERIES CX

- Material: EN 1.4301 (AISI 304) s/s, finely satin-finished and protected. Thickness: 20/10 for the door and 15/10 for cabinet and side panes
- Front door, blind or with glass (crashproof 3+3 security glass), with stiffening drilled s/s frame to support equipment and/or secure cableducts and accessories,
On request blind door can also be equipped with partial windows and different materials can be used (polycarbonate or alluminium for silk printing)
- No rear access and no removable top panel: top panel and rear part are obtained from a single sheet.
- Removable side panes, bolted, to be ordered separately
- Twin-lock with outside faceplate made of glass-loaded black polyamide, 4 point-closing, and BT key. On request can be replaced by other types of door locks (see accessories for cabinets).
- One fairlead plate with 1-piece seal (3 part seals on demand)
- AISI 316 s/s inner hinges, for 120° opening as per CEI EN 60204-1 recommendations
- Max weight the door can stand: 30 kg
- Seal of foamed polyurethane, applied by robotized system
- Inner plate of sendzimir to be ordered separately (see accessories for cabinets)
- Pre-arranged for earthing in compliance with the applicable laws force
- Protection degree: IP66 (modules L.1200 IP65).

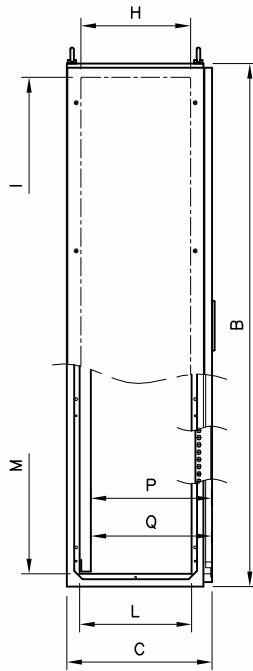
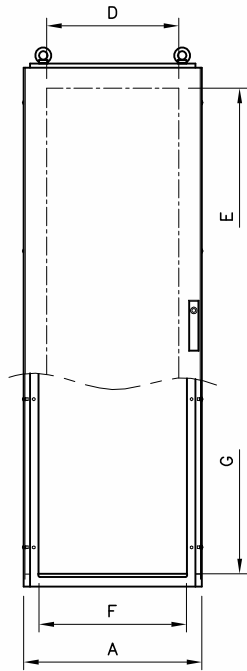

Blind door

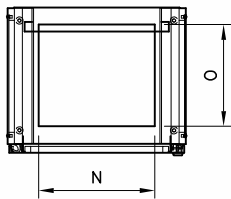
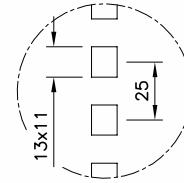

Underwriters Laboratories

IP66

EN 60 529



TYPE NEMA

4X, 4, 12, 1

Standard UL508A - UL50 Standard 250



EN 60204-1 89/392/EEC

| CABINET | | | | | | | | | | | | | | OPTIONALS | | | | | |
|---------|------------|------|------|------------------|------|-------------|------|-------------------|------|------------|------|-------------|-----|-------------|-----|-------------|-----|------|-------|
| ITEM. | Out. sizes | | | door useful size | | front entry | | panel useful size | | Side entry | | cable entry | | INNER PLATE | | SIDE PANELS | | | |
| | A | B | C | D | E | F | G | H | I | L | M | N | O | P** | Q** | ITEM.* | X | Y | ITEM. |
| CX0685 | 614 | 500 | 1800 | 455 | 1630 | 508 | 1712 | 377 | 1704 | 385 | 1712 | 385 | 350 | 440 | 415 | PA0517 | 497 | 1692 | CX85 |
| CX0686 | 614 | 1800 | 600 | 455 | 1630 | 508 | 1712 | 477 | 1704 | 485 | 1712 | 385 | 450 | 540 | 515 | PA0517 | 497 | 1692 | CX86 |
| CX0885 | 814 | 1800 | 500 | 655 | 1630 | 708 | 1712 | 377 | 1704 | 385 | 1712 | 585 | 350 | 440 | 415 | PA0717 | 697 | 1692 | CX85 |
| CX0886 | 814 | 1800 | 600 | 655 | 1630 | 708 | 1712 | 477 | 1704 | 485 | 1712 | 585 | 450 | 540 | 515 | PA0717 | 697 | 1692 | CX86 |
| CX1085 | 1014 | 1800 | 500 | 855 | 1630 | 908 | 1712 | 377 | 1704 | 385 | 1712 | 785 | 350 | 440 | 415 | PA0917 | 897 | 1692 | CX85 |
| CX1086 | 1014 | 1800 | 600 | 855 | 1630 | 908 | 1712 | 477 | 1704 | 485 | 1712 | 785 | 450 | 540 | 515 | PA0917 | 897 | 1692 | CX86 |
| CX0605 | 614 | 2000 | 500 | 455 | 1830 | 508 | 1912 | 377 | 1904 | 385 | 1912 | 385 | 350 | 440 | 415 | PA0519 | 497 | 1892 | CX05 |
| CX0606 | 614 | 2000 | 600 | 455 | 1830 | 508 | 1912 | 477 | 1904 | 485 | 1912 | 385 | 450 | 540 | 515 | PA0519 | 497 | 1892 | CX06 |
| CX0805 | 814 | 2000 | 500 | 655 | 1830 | 708 | 1912 | 377 | 1904 | 385 | 1912 | 585 | 350 | 440 | 415 | PA0719 | 697 | 1892 | CX05 |
| CX0806 | 814 | 2000 | 600 | 655 | 1830 | 708 | 1912 | 477 | 1904 | 485 | 1912 | 585 | 450 | 540 | 515 | PA0719 | 697 | 1892 | CX06 |
| CX1005 | 1014 | 2000 | 500 | 855 | 1830 | 908 | 1912 | 377 | 1904 | 385 | 1912 | 785 | 350 | 440 | 415 | PA0919 | 897 | 1892 | CX05 |
| CX1006 | 1014 | 2000 | 600 | 855 | 1830 | 908 | 1912 | 477 | 1904 | 485 | 1912 | 785 | 450 | 540 | 515 | PA0919 | 897 | 1892 | CX06 |

REMARK: Total width side panels included: dim: "A" + 9 mm

*P Max. distance between door inside and inner plate, when fixing is by stirrups
*Q Max. distance between door inside and inner plate, when fixing is by slides

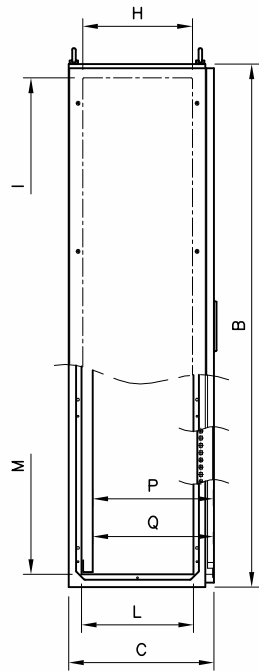
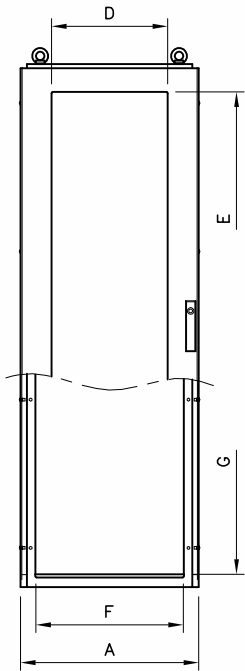

door with glass

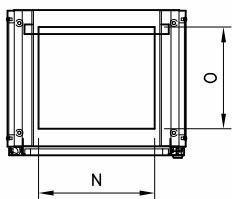
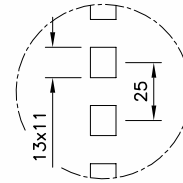



| | | | |
|--|----------------------------------|---------------------|-------------------------------------|
| | Underwriters Laboratories | IP66 | EN 60 529 |
| | TYPE NEMA | 4X, 12, 1, 4 | Standard UL508A - UL50 Standard 250 |
| | | | EN 60-204-1 89/392/EEC |

| CABINET | | | | | | | | | | | | | | OPTIONALS | | | | | |
|----------------|------|------|--------------|-----|-------------|-----|-------------------|-----|------------|-----|-------------|-----|-----|-----------|-------------|---------------|-----|-------------|-------------|
| Out. sizes | | | Visible size | | front entry | | panel useful size | | side entry | | cable entry | | | | INNER PLATE | | | SIDE PANELS | |
| ITEM. | A | B | C | D | E | F | G | H | I | L | M | N | O | P** | Q** | ITEM.* | X | Y | ITEM. |
| CXV0685 | 614 | 1800 | 500 | 400 | 1600 | 508 | 1712 | 377 | 1704 | 385 | 1712 | 385 | 350 | 435 | 410 | PA0517 | 497 | 1692 | CX85 |
| CXV0686 | 614 | 1800 | 600 | 400 | 1600 | 508 | 1712 | 477 | 1704 | 485 | 1712 | 385 | 450 | 535 | 510 | PA0517 | 497 | 1692 | CX86 |
| CXV0885 | 814 | 1800 | 500 | 600 | 1600 | 708 | 1712 | 377 | 1704 | 385 | 1712 | 585 | 350 | 435 | 410 | PA0717 | 697 | 1692 | CX85 |
| CXV0886 | 814 | 1800 | 600 | 600 | 1600 | 708 | 1712 | 477 | 1704 | 485 | 1712 | 585 | 450 | 535 | 510 | PA0717 | 697 | 1692 | CX86 |
| CXV1085 | 1014 | 1800 | 500 | 800 | 1600 | 908 | 1712 | 377 | 1704 | 385 | 1712 | 785 | 350 | 435 | 410 | PA0917 | 897 | 1692 | CX85 |
| CXV1086 | 1014 | 1800 | 600 | 800 | 1600 | 908 | 1712 | 477 | 1704 | 485 | 1712 | 785 | 450 | 535 | 510 | PA0917 | 897 | 1692 | CX86 |
| CXV0605 | 614 | 2000 | 500 | 400 | 1800 | 508 | 1912 | 377 | 1904 | 385 | 1912 | 385 | 350 | 435 | 410 | PA0519 | 497 | 1892 | CX05 |
| CXV0606 | 614 | 2000 | 600 | 400 | 1800 | 508 | 1912 | 477 | 1904 | 485 | 1912 | 385 | 450 | 535 | 510 | PA0519 | 497 | 1892 | CX06 |
| CXV0805 | 814 | 2000 | 500 | 600 | 1800 | 708 | 1912 | 377 | 1904 | 385 | 1912 | 585 | 350 | 435 | 410 | PA0719 | 697 | 1892 | CX05 |
| CXV0806 | 814 | 2000 | 600 | 600 | 1800 | 708 | 1912 | 477 | 1904 | 485 | 1912 | 585 | 450 | 535 | 510 | PA0719 | 697 | 1892 | CX06 |
| CXV1005 | 1014 | 2000 | 500 | 800 | 1800 | 908 | 1912 | 377 | 1904 | 385 | 1912 | 785 | 350 | 435 | 410 | PA0919 | 897 | 1892 | CX05 |
| CXV1006 | 1014 | 2000 | 600 | 800 | 1800 | 908 | 1912 | 477 | 1904 | 485 | 1912 | 785 | 450 | 535 | 510 | PA0919 | 897 | 1892 | CX06 |

* see accessories on page 36

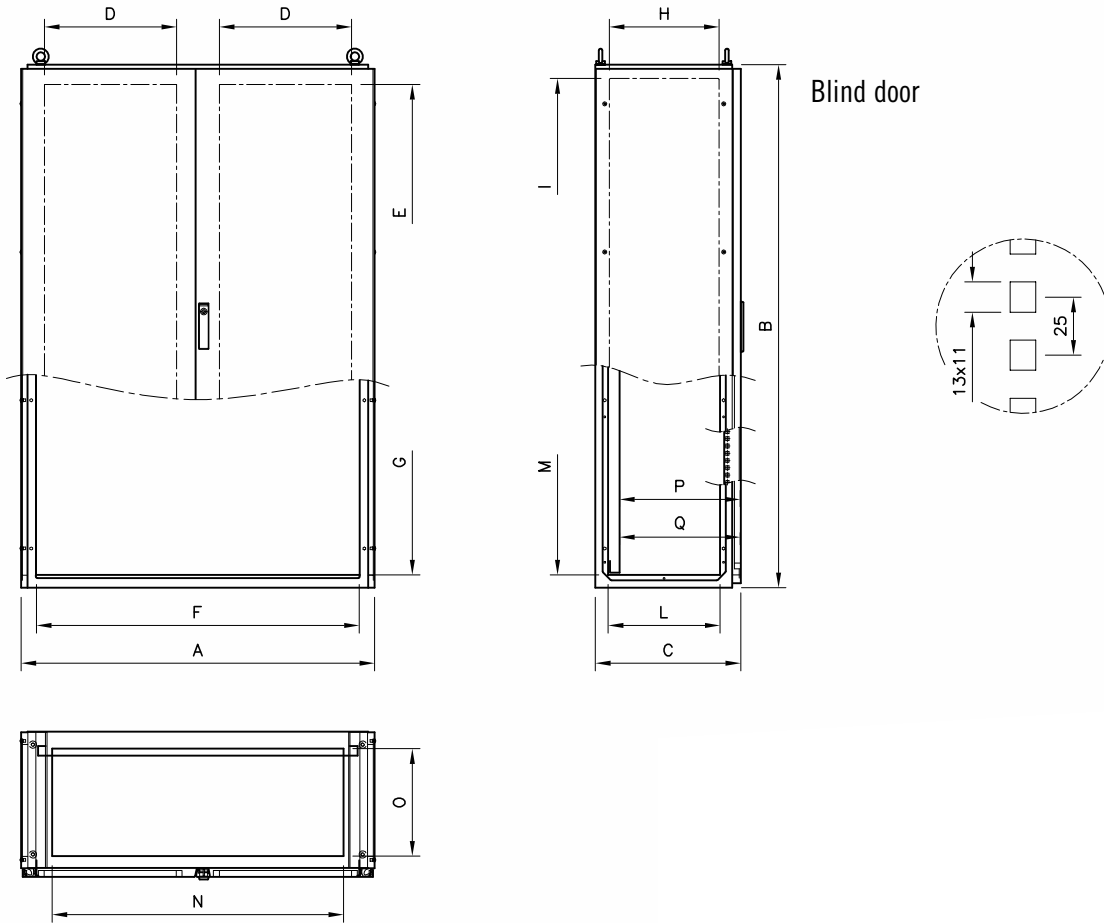
*P Max. distance between door inside and inner plate, when fixing is by stirrups
 *Q Max. distance between door inside and inner plate, when fixing is by slides



| | | | |
|--|------------------|--------------|-------------------------------------|
| | | IP65 | EN 60 529 |
|  | TYPE NEMA | 12, 1 | Standard UL508A - UL50 Standard 250 |
|  | | | EN 60204-1 89/392/EEC |

| CABINET | | | | | | | | | | | | | | OPTIONALS | | | | | |
|---------------|------|------|------------------|-----|-------------|------|-------------------|-----|------------|-----|-------------|-----|-------------|-----------|-----|---------------|------|------|-------------|
| Out.sizes | | | door useful size | | front entry | | panel useful size | | side entry | | cable entry | | INNER PLATE | | | SIDE PANELS | | | |
| ITEM. | A | B | C | D | E | F | G | H | I | L | M | N | O | P** | Q** | ITEM.* | X | Y | ITEM. |
| CX1285 | 1217 | 1800 | 500 | 455 | 1630 | 1111 | 1712 | 377 | 1704 | 385 | 1712 | 988 | 350 | 440 | 415 | PA1117 | 1100 | 1682 | CX85 |
| CX1286 | 1217 | 1800 | 600 | 455 | 1630 | 1111 | 1712 | 477 | 1704 | 485 | 1712 | 988 | 450 | 540 | 515 | PA1117 | 1100 | 1682 | CX86 |
| CX1205 | 1217 | 2000 | 500 | 455 | 1830 | 1111 | 1912 | 377 | 1904 | 385 | 1912 | 988 | 350 | 440 | 415 | PA1119 | 1100 | 1892 | CX05 |
| CX1206 | 1217 | 2000 | 600 | 455 | 1830 | 1111 | 1912 | 477 | 1904 | 485 | 1912 | 988 | 450 | 540 | 515 | PA1119 | 1100 | 1892 | CX06 |

*P Max. distance between door inside and inner plate, when fixing is by stirrups
 *Q Max. distance between door inside and inner plate, when fixing is by slides

* voir accessoires page 36

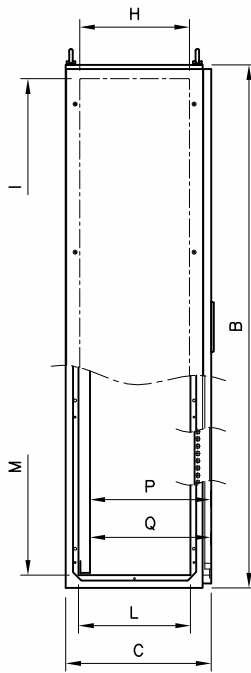
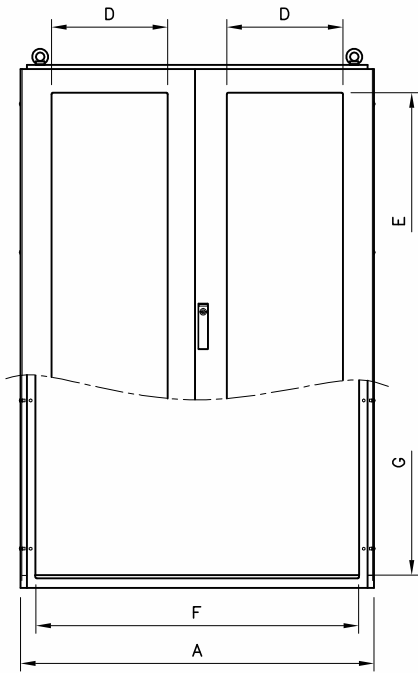

Door with glass

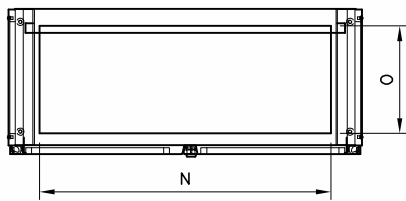
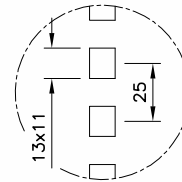

| | | |
|--|------------------------|-------------------------------------|
| | IP65 | EN 60 529 |
| | TYPE NEMA 12, 1 | Standard UL508A - UL50 Standard 250 |
| | | EN 60204-1 89/392/EEC |

| CABINET | | | | | | | | | | | | | | | OPTIONALS | | | | | |
|------------------|------|------|--------------|-----|-------------|------|-------------------|-----|------------|-----|-------------|-----|-----|-----|-----------|-----------------------|---------------|------|-------------|-------------|
| Out. sizes | | | Visible size | | front entry | | panel useful size | | side entry | | cable entry | | | | Notes | INNER PLATE | | | SIDE PANELS | |
| ITEM. | A | B | C | D | E | F | G | H | I | L | M | N | O | P** | Q** | | ITEM.* | X | Y | ITEM. |
| CXV1285SX | 1217 | 1800 | 500 | 400 | 1600 | 1111 | 1712 | 377 | 1704 | 385 | 1712 | 988 | 350 | 435 | 410 | left door with glass | PA1117 | 1100 | 1692 | CX85 |
| CXV1286DX | 1217 | 1800 | 600 | 400 | 1600 | 1111 | 1712 | 477 | 1704 | 485 | 1712 | 988 | 450 | 535 | 510 | right door with glass | PA1117 | 1100 | 1692 | CX86 |
| CXV1285 | 1217 | 1800 | 500 | 400 | 1600 | 1111 | 1712 | 377 | 1704 | 385 | 1712 | 988 | 350 | 435 | 410 | both doors with glass | PA1117 | 1100 | 1692 | CX85 |
| CXV1286SX | 1217 | 1800 | 600 | 400 | 1600 | 1111 | 1712 | 477 | 1704 | 485 | 1712 | 988 | 450 | 535 | 510 | left door with glass | PA1117 | 1100 | 1692 | CX86 |
| CXV1285DX | 1217 | 1800 | 500 | 400 | 1600 | 1111 | 1712 | 377 | 1704 | 385 | 1712 | 988 | 350 | 435 | 410 | right door with glass | PA1117 | 1100 | 1692 | CX85 |
| CXV1286 | 1217 | 1800 | 600 | 400 | 1600 | 1111 | 1712 | 477 | 1704 | 485 | 1712 | 988 | 450 | 535 | 510 | both doors with glass | PA1117 | 1100 | 1692 | CX86 |
| CXV1205SX | 1217 | 2000 | 500 | 400 | 1800 | 1111 | 1912 | 377 | 1904 | 385 | 1912 | 988 | 350 | 435 | 410 | left door with glass | PA1119 | 1100 | 1892 | CX05 |
| CXV1206DX | 1217 | 2000 | 600 | 400 | 1800 | 1111 | 1912 | 477 | 1904 | 485 | 1912 | 988 | 450 | 535 | 510 | right door with glass | PA1119 | 1100 | 1892 | CX06 |
| CXV1205 | 1217 | 2000 | 500 | 400 | 1800 | 1111 | 1912 | 377 | 1904 | 385 | 1912 | 988 | 350 | 435 | 410 | both doors with glass | PA1119 | 1100 | 1892 | CX05 |
| CXV1206SX | 1217 | 2000 | 600 | 400 | 1800 | 1111 | 1912 | 477 | 1904 | 485 | 1912 | 988 | 450 | 535 | 510 | left door with glass | PA1119 | 1100 | 1892 | CX06 |
| CXV1205DX | 1217 | 2000 | 500 | 400 | 1800 | 1111 | 1912 | 377 | 1904 | 385 | 1912 | 988 | 350 | 435 | 410 | right door with glass | PA1119 | 1100 | 1892 | CX05 |
| CXV1206 | 1217 | 2000 | 600 | 400 | 1800 | 1111 | 1912 | 477 | 1904 | 485 | 1912 | 988 | 450 | 535 | 510 | both doors with glass | PA1119 | 1100 | 1892 | CX06 |

*P Max. distance between door inside and inner plate, when fixing is by stirrups
 *Q Max. distance between door inside and inner plate, when fixing is by slides

* see accessories on page 36

"RX" VERSION WITH BOLTED FRONT PANEL

"RXP" VERSION WITH HINGED FRONT DOOR

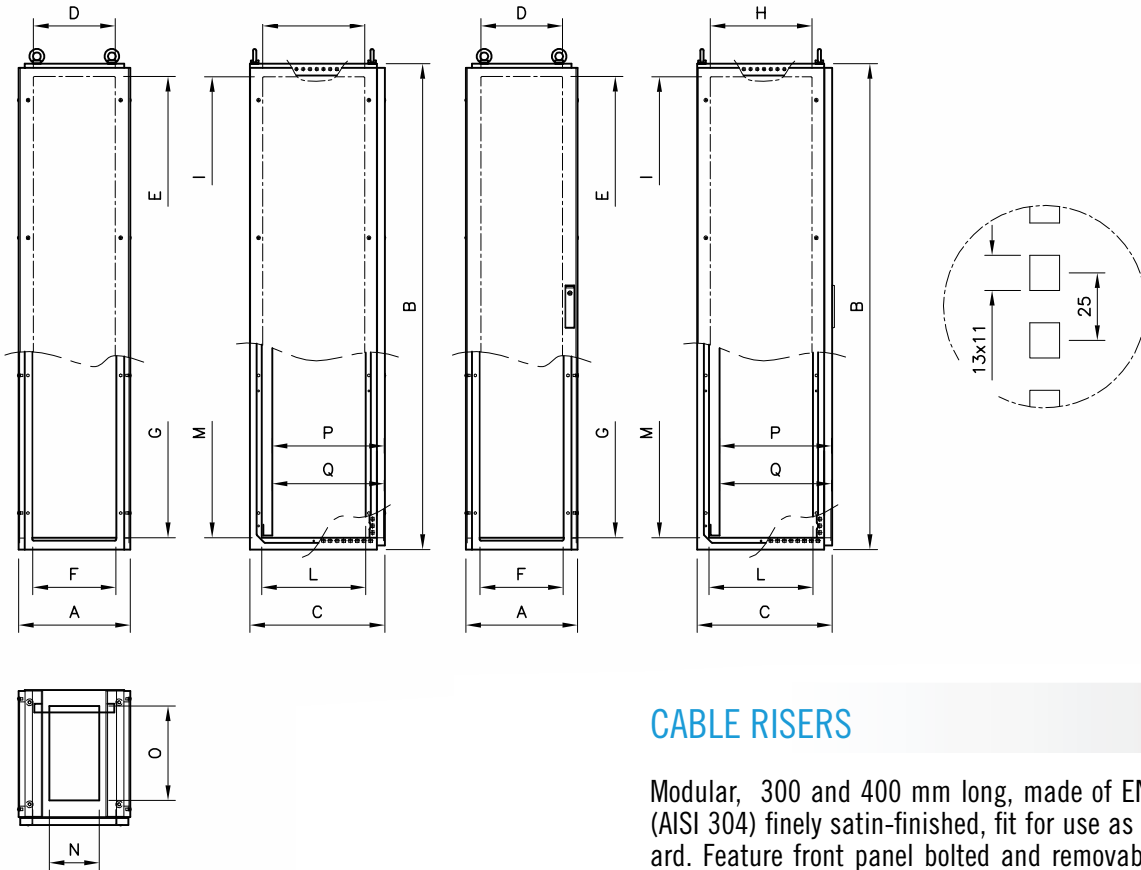

CABLE RISERS

Modular, 300 and 400 mm long, made of EN 1.4301 s/s (AISI 304) finely satin-finished, fit for use as terminal board. Feature front panel bolted and removable or hinged blind door. Back side and top not accessible Prearranged to receive standard side panels, partition baffles and plinths h.100 and 200 mm. Available in 2 different depths and two heights, to match perfectly all types of monobloc cabinets. Protection degree: IP66

UL Underwriters Laboratories IP66 EN 60 529
 c UL US LISTED TYPE NEMA 4X, 12, 1, 4 Standard UL508A - UL50 Standard 250
 CE EN 60-204-1 89/392/EEC

| CABINET | | | | | | | | | | | | | | OPTIONALS | | | | | |
|---------|-------------|------|-----|-------------|------|-------------------|------|------------|------|-------------|------|-------------|-----|-----------|-------------|--------|--------|------|------|
| ITEM. | inner usefu | | | space front | | panel useful size | | side entry | | cable entry | | INNER PLATE | | | SIDE PANELS | | | | |
| | A | B | C | D | E | F | G | H | I | L | M | N | O | P** | | Q** | ITEM.* | X | Y |
| RX0385 | 314 | 1800 | 500 | 203 | 1706 | 385 | 1712 | 377 | 1704 | 385 | 1712 | 85 | 350 | 440 | 415 | PA0217 | 197 | 1692 | CX85 |
| RX0386 | 314 | 1800 | 600 | 203 | 1706 | 485 | 1712 | 477 | 1704 | 485 | 1712 | 85 | 450 | 540 | 515 | PA0217 | 197 | 1692 | CX86 |
| RX0305 | 314 | 2000 | 500 | 203 | 1906 | 385 | 1912 | 377 | 1904 | 385 | 1912 | 85 | 350 | 440 | 415 | PA0219 | 197 | 1892 | CX05 |
| RX0306 | 314 | 2000 | 600 | 203 | 1906 | 485 | 1912 | 477 | 1904 | 485 | 1912 | 85 | 450 | 540 | 515 | PA0219 | 197 | 1892 | CX06 |
| RX0485 | 414 | 1800 | 500 | 303 | 1706 | 385 | 1712 | 377 | 1704 | 385 | 1712 | 185 | 350 | 440 | 415 | PA0317 | 297 | 1692 | CX85 |
| RX0486 | 414 | 1800 | 600 | 303 | 1706 | 485 | 1712 | 477 | 1704 | 485 | 1712 | 185 | 450 | 540 | 515 | PA0317 | 297 | 1692 | CX86 |
| RX0405 | 414 | 2000 | 500 | 303 | 1906 | 385 | 1912 | 377 | 1904 | 385 | 1912 | 185 | 350 | 440 | 415 | PA0319 | 297 | 1892 | CX05 |
| RX0406 | 414 | 2000 | 600 | 303 | 1906 | 485 | 1912 | 477 | 1904 | 485 | 1912 | 185 | 450 | 540 | 515 | PA0319 | 297 | 1892 | CX06 |
| RXP0385 | 314 | 1800 | 500 | 203 | 1706 | 385 | 1712 | 377 | 1704 | 385 | 1712 | 85 | 350 | 440 | 415 | PA0217 | 197 | 1692 | CX85 |
| RXP0386 | 314 | 1800 | 600 | 203 | 1706 | 485 | 1712 | 477 | 1704 | 485 | 1712 | 85 | 450 | 540 | 515 | PA0217 | 197 | 1692 | CX86 |
| RXP0305 | 314 | 2000 | 500 | 203 | 1906 | 385 | 1912 | 377 | 1904 | 385 | 1912 | 85 | 350 | 440 | 415 | PA0219 | 197 | 1892 | CX05 |
| RXP0306 | 314 | 2000 | 600 | 203 | 1906 | 485 | 1912 | 477 | 1904 | 485 | 1912 | 85 | 450 | 540 | 515 | PA0219 | 197 | 1892 | CX06 |
| RXP0485 | 414 | 1800 | 500 | 303 | 1706 | 385 | 1712 | 377 | 1704 | 385 | 1712 | 185 | 350 | 440 | 415 | PA0317 | 297 | 1692 | CX85 |
| RXP0486 | 414 | 1800 | 600 | 303 | 1706 | 485 | 1712 | 477 | 1704 | 485 | 1712 | 185 | 450 | 540 | 515 | PA0317 | 297 | 1692 | CX86 |
| RXP0405 | 414 | 2000 | 500 | 303 | 1906 | 385 | 1912 | 377 | 1904 | 385 | 1912 | 185 | 350 | 440 | 415 | PA0319 | 297 | 1892 | CX05 |
| RXP0406 | 414 | 2000 | 600 | 303 | 1906 | 485 | 1912 | 477 | 1904 | 485 | 1912 | 185 | 450 | 540 | 515 | PA0319 | 297 | 1892 | CX06 |

*P Max. distance between door inside and inner plate, when fixing is by stirrups
 *Q Max. distance between door inside and inner plate, when fixing is by slides



PAIR OF SIDE PANELS

Made of stainless steel EN 1.4301 (AISI 304) s/s finely satin-finished and protected, thickn. 15/10, for direct installation outside the module or the multi-module unit, securing them to the frame from the outside by 8 oval-headed s/s screws.

| ITEM. | DIMENSIONS | | FOR CABINETS |
|-------------|------------|------|---|
| | L | H | |
| CX85 | 467,5 | 1785 | CX-CXV0685 CX-CXV0885-CX CXV1085 CX-CXV1285 |
| CX86 | 567,5 | 1785 | CX-CXV0686 CX-CXV0886-CX CXV1086 CX-CXV1286 |
| CX05 | 467,5 | 1985 | CX-CXV0605 CX-CXV0805-CX CXV1005 CX-CXV1205 |
| CX06 | 567,5 | 1985 | CX-CXV0606 CX-CXV0806-CX CXV1006 CX-CXV1206 |



MULTIPLE FAIRLEAD PLATES

The standard fairlead plates of CX cabinets, in a single piece, can be replaced by 3-piece multiple fairlead plates. The multiple fairlead plates PCX are essential when sash-type fairlead plates are used.

| | | |
|----------------|-------------------------------------|---------------|
| PCX0605 | Kit of multiple fairlead plates for | CX0685 CX0605 |
| PCX0606 | Kit of multiple fairlead plates for | CX0686 CX0606 |
| PCX0805 | Kit of multiple fairlead plates for | CX0885 CX0805 |
| PCX0806 | Kit of multiple fairlead plates for | CX0886 CX0806 |
| PCX1005 | Kit of multiple fairlead plates for | CX1085 CX1005 |
| PCX1006 | Kit of multiple fairlead plates for | CX1086 CX1006 |
| PCX1205 | Kit of multiple fairlead plates for | CX1285 CX1205 |
| PCX1206 | Kit of multiple fairlead plates for | CX1285 CX1206 |



ADJUSTABLE UPPER CROSS PIECE

Section 26X42mm. Available for all depths of cabinets, they are delivered complete with clamp screws. Can be used to secure lamps, fix cables and are indispensable for fixing the interlocks.

- **TRS06** - or depth. 600
- **TRS08** - or depth. 800
- **TRS10** - or depth. 1000
- **TRS12** - or depth. 1200



KIT FOR MODULE COUPLING

Essential to couple several modules in a battery, it includes the closed cell foamed seal, the screws and the special nuts for easy assembling.

- **CK185** - for cabinets H. 1800 P. 500
- **CK186** - for cabinets H. 1800 P. 600
- **CK205** - for cabinets H. 2000 P. 500
- **CK206** - for cabinets H. 2000 P. 600



PARTITION Baffles

Panel made of sendzimir sheet EN 10142 thickness 25/10, for installation between two modules in order to create a gap between them. Available in two versions: protection degree IP20 and protection degree IP65; on request it can be drilled for cable passage between two modules and for connectors.

REMARK: the partition baffle excludes the intermediate plate

| ITEM. | protection degree | POUR ARMOIRES |
|----------------|-------------------|--|
| STCX285 | IP20 | CX-CXV0685 CX-CXV0885 CX-CXV1085 CX-CXV1285 CX-CXV1685 |
| STCX286 | IP20 | CX-CXV0686 CX-CXV0886 CX-CXV1086 CX-CXV1286 CX-CXV1686 |
| STCX288 | IP20 | CX-CXV0688 CX-CXV0888 CX-CXV1088 CX-CXV1288 CX-CXV1688 |
| STCX205 | IP20 | CX-CXV0605 CX-CXV0805 CX-CXV1005 CX-CXV1205 CX-CXV1605 |
| STCX206 | IP20 | CX-CXV0606 CX-CXV0806 CX-CXV1006 CX-CXV1206 CX-CXV1606 |
| STCX208 | IP20 | CX-CXV0608-CX-CXV0808 CX-CXV1008 CX-CXV1208 CX-CXV1608 |
| STCX685 | IP65 | CX-CXV0685 CX-CXV0885 CX-CXV1085 CX-CXV1285 CX-CXV1685 |
| STCX686 | IP65 | CX-CXV0686 CX-CXV0886 CX-CXV1086 CX-CXV1286 CX-CXV1686 |
| STCX688 | IP65 | CX-CXV0688 CX-CXV0888 CX-CXV1088 CX-CXV1288 CX-CXV1688 |
| STCX605 | IP65 | CX-CXV0605 CX-CXV0805 CX-CXV1005 CX-CXV1205 CX-CXV1605 |
| STCX606 | IP65 | CX-CXV0606 CX-CXV0806 CX-CXV1006 CX-CXV1206 CX-CXV1606 |
| STCX608 | IP65 | CX-CXV0608 CX-CXV0808 CX-CXV1008 CX-CXV1208 CX-CXV1608 |



DEPTH CROSSPIECES WITH SIDE FIXING

Section 22x50mm.

Available for all depth of cabinets, they are delivered complete with screws and fixing stirrup. Can be used to secure cables, fixing vertical section bars. Ideal to secure and adjust the depth of DIN supports

- **PRF255CX** - for depth. 500 - couple
- **PRF256CX** - for depth. 600 - couple

REMARK: essential for "UL" certification

accessories for cabinets



OVER-DOOR PANELS
pag. 47



INNER DOORS
pag. 52



WORK PLANES
pag. 53



WORK TABLETOPS
pag. 55



INNER PLATES PA TYPE
pag. 48



INNER PLATES PS TYPE
pag. 48



VERTICAL SLASH TYPE CLOSURE PLATES
pag. 53



ECROU A CAGE
pag. 51



INTERMEDIATE PLATE
pag. 49



DOOR CROSSPIECES
pag. 54



BEARING SECTION BARS
pag. 49



HOISTING EYEBOLTS
pag. 54



PANELS
pag. 55



SKIRTING
pag. 50



SYSTEMS FOR MODULAR SWITCHES
pag. 56



5,5 SELF-TAPPING SCREWS
pag. 51



LOCKING-PROOF DEVICE
pag. 59



FOOT SAFETY DEVICE
pag. 60



WHEELS
pag. 60



HOISTING RODS
pag. 51



SLIDE BARS
pag. 54



HOISTING STIRRUPS
pag. 51



LAMPE
pag. 61



DIAGRAM POCKETS
pag. 59



SUPPORTS WITH DIN BARS
pag. 57 old.



LOCKS
pag. 58



TAPS
pag. 60



ADJUSTABLE FEET
pag. 49



FIXED LECTERNS
pag. 59



ELECTROCONDUCTIVE GASKET
pag. 61

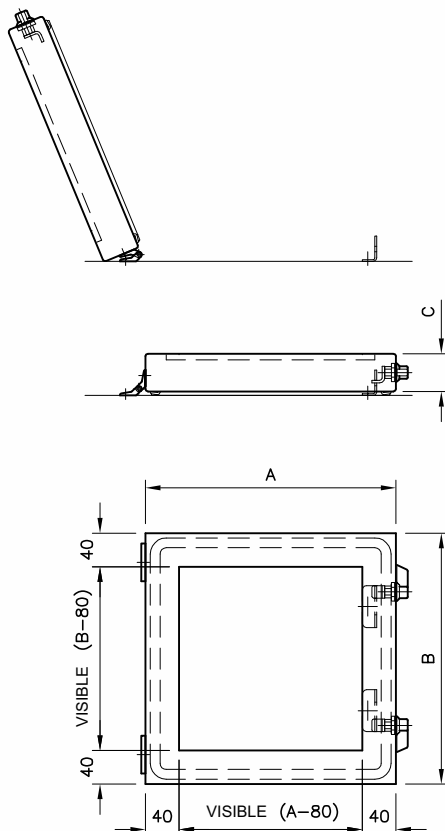

OVERDOORS

Realized in stainless steel X5 CrNi 18/10 EN 1.4301 (AISI 304) finely satin-finished, with 3+3 layer shatterproof glass, are suitable when instrumentations applied on the external door have to be protected. Complete with wing-nut lock, galvanized, black, with Yale type key and build-in seal, 180° opening. Protection degree IP65.

REMARK: when set on width exceeding the width of the over-door panel, the max. opening is 90°.

| ITEM. | A | B | C |
|----------|------|------|----|
| SV33/45 | 300 | 300 | 45 |
| SV34/45 | 300 | 450 | 45 |
| SV36/45 | 300 | 600 | 45 |
| SV43/45 | 450 | 300 | 45 |
| SV44/45 | 450 | 450 | 45 |
| SV46/45 | 450 | 600 | 45 |
| SV64/45 | 600 | 450 | 45 |
| SV66/45 | 600 | 600 | 45 |
| SV67/45 | 600 | 750 | 45 |
| SV68/45 | 600 | 800 | 45 |
| SV69/45 | 600 | 900 | 45 |
| SV612/45 | 600 | 1200 | 45 |
| SV77/45 | 750 | 750 | 45 |
| SV710/45 | 750 | 1000 | 45 |
| SV86/45 | 800 | 600 | 45 |
| SV812/45 | 800 | 1200 | 45 |
| SV106/45 | 1000 | 750 | 45 |

| ITEM. | A | B | C |
|----------|------|------|----|
| SV33/75 | 300 | 300 | 75 |
| SV34/75 | 300 | 450 | 75 |
| SV36/75 | 300 | 600 | 75 |
| SV43/75 | 450 | 300 | 75 |
| SV44/75 | 450 | 450 | 75 |
| SV46/75 | 450 | 600 | 75 |
| SV64/75 | 600 | 450 | 75 |
| SV66/75 | 600 | 600 | 75 |
| SV67/75 | 600 | 750 | 75 |
| SV68/75 | 600 | 800 | 75 |
| SV69/75 | 600 | 900 | 75 |
| SV612/75 | 600 | 1200 | 75 |
| SV77/75 | 750 | 750 | 75 |
| SV710/75 | 750 | 1000 | 75 |
| SV86/75 | 800 | 600 | 75 |
| SV812/75 | 800 | 1200 | 75 |
| SV106/75 | 1000 | 750 | 75 |

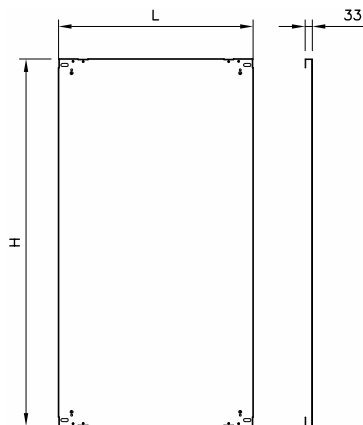

INNER PLATE TYPE PA

Realized in galvanized sheet sendzimir EN 10142 , bent on all sides for maximum stiffness; supplied in assembling kit, adjustable over the whole depth of the cabinet.

| ITEM. | SIZES | | FOR CABINETS SERIE MC-CX-CC | |
|--------|-------|------|-----------------------------|--------|
| | X | Y | | |
| PA0517 | 497 | 1692 | L.600 | H.1800 |
| PA0717 | 697 | 1692 | L.800 | H.1800 |
| PA1115 | 1100 | 1492 | L.1200 | H.1600 |
| PA1117 | 1100 | 1692 | L.1200 | H.1800 |
| PA1515 | 1500 | 1492 | L.1600 | H.1600 |
| PA1517 | 1505 | 1692 | L.1600 | H.1800 |
| PA0519 | 497 | 1892 | L.600 | H.2000 |
| PA0719 | 697 | 1892 | L.800 | H.2000 |
| PA0919 | 897 | 1892 | L.1000 | H.2000 |
| PA1119 | 1100 | 1892 | L.1200 | H.2000 |
| PA1519 | 1505 | 1892 | L.1600 | H.2000 |

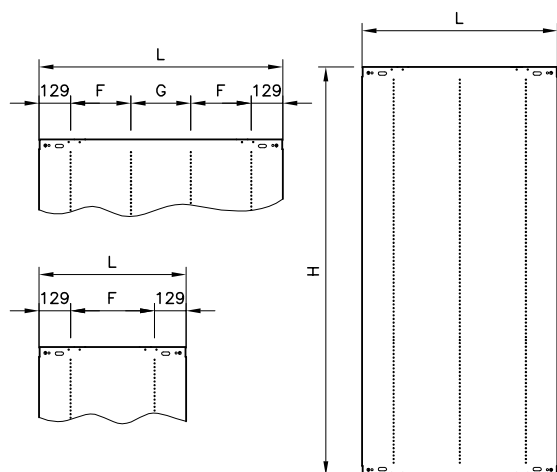

INNER PLATES TYPE PS

Realized in galvanized sheet sendzimir EN 10142, designed to allow the use of all the cabinet width. The use of these plates set in battery does not require an intermediate place since they can be connected directly one to the other.

REMARK: 2 plates PS0817 or PS0819 are required depending on the height are required for cabinets L.1600.

| ITEM. | L | H | F | G | FOR CABINET |
|--------|------|------|-----|-----|--|
| PS0617 | 608 | 1692 | 350 | / | MC0685 - MC0686 - MC0688 - CX0685 - CX0686 |
| PS0619 | 608 | 1892 | 350 | / | MC0605 - MC0606 - MC0608 - CX0605 - CX0606 |
| PS0817 | 808 | 1692 | 275 | / | MC0885 - MC0886 - MC0888 - CX0885 - CX0886 |
| PS0819 | 808 | 1892 | 275 | / | MC0805 - MC0806 - MC0808 - CX0805 - CX0806 |
| PS1017 | 1008 | 1692 | 250 | 250 | MC1085 - MC1086 - MC1088 - CX1085 - CX1086 |
| PS1019 | 1008 | 1892 | 250 | 250 | MC1005 - MC1006 - MC1008 - CX1005 - CX1006 |
| PS1217 | 1211 | 1692 | 325 | 300 | MC1285 - MC1286 - MC1288 - CX1285 - CX1286 |
| PS1219 | 1211 | 1892 | 325 | 300 | MC1205 - MC1206 - MC1208 - CX1205 - CX1206 |



INTERMEDIATE PLATE

Designed to be assembled and disassembled even with pre-assembled and wired inner plates. Made of sendzimir EN 10142, it comes complete with all assembling accessories, in particular 2 stiffening flat bars that form with the inner plates a stiff single assembling plane. When this plate is used, it will not be possible to set the plate far back but only in front of the rear uprights.

- **PA0117** - intermediate plate for cabinets h.1800
- **PA0119** - intermediate plate for cabinets h.2000

REMARK: the intermediate plate exclude the use of the partition baffles



SUPPORT SECTION BARS

System of section bars, suitable to support heavy instrumentations (i.e. transformers). Supplied in assembling kit of 2 pcs, they are drilled to allow ample adjusting.

- **ST0600** - for modular cabinets MC L.600
- **ST0800** - for modular cabinets MC L.800 et L.1600 (*)
- **ST1000** - for modular cabinets MC L.1000
- **ST1200** - for modular cabinets MC L.1200

(*) **REMARK:** for cabinets MC 1600 it is necessary to require nr. 2 items ST0800. Just for MC-CX



ADJUSTABLE FEET

Cylindrical foot perfectly cleanable in AISI 304 s/s

- **SA2000**: adjustable from 125 à 165 mm
- **SA2200**: adjustable from 165 à 205 mm

SKIRTING



Simple and sturdy execution, they are made of EN 1.4301 s/s (AISI 304) carefully satin-finished and protected. Prearranged for side and back cable entry (or front) and for application of feet, where the need be ; the bottom is open to the ground: on request, they can be delivered with panels for bottom closing that can be used also as cable supports. Protection degree is IP20 with bottom pannel in place. Can be delivered either in assembling kit or pre-assembled, complete with the necessary kit for securing to the ground. Available in 100 and 200 mm height.

| ITEM. | Height mm | For cabinets CC-CX-MC | Bottom closing panel |
|---------|-----------|-----------------------|----------------------|
| ZA03105 | 100 | L.300-P.500 | P0305 |
| ZA03205 | 200 | L.300-P.500 | P0305 |
| ZA03106 | 100 | L.300-P.600 | P0306 |
| ZA03206 | 200 | L.300-P.600 | P0306 |
| ZA03108 | 100 | L.300-P.800 | P0308 |
| ZA03208 | 200 | L.300-P.800 | P0308 |
| ZA04105 | 100 | L.400-P.500 | P0405 |
| ZA04205 | 200 | L.400-P.500 | P0405 |
| ZA04106 | 100 | L.400-P.600 | P0406 |
| ZA04206 | 200 | L.400-P.600 | P0406 |
| ZA04108 | 100 | L.400-P.800 | P0408 |
| ZA04208 | 200 | L.400-P.800 | P0408 |
| ZA06105 | 100 | L.600-P.500 | P0605 |
| ZA06205 | 200 | L.600-P.500 | P0605 |
| ZA06106 | 100 | L.600-P.600 | P0606 |
| ZA06206 | 200 | L.600-P.600 | P0606 |
| ZA06108 | 100 | L.600-P.800 | P0608 |
| ZA06208 | 200 | L.600-P.800 | P0608 |
| ZA08105 | 100 | L.800-P.500 | P0805 |
| ZA08205 | 200 | L.800-P.500 | P0805 |
| ZA08106 | 100 | L.800-P.600 | P0806 |
| ZA08206 | 200 | L.800-P.600 | P0806 |
| ZA08108 | 100 | L.800-P.800 | P0808 |
| ZA08208 | 200 | L.800-P.800 | P0808 |
| ZA10105 | 100 | L.1000-P.500 | P1005 |
| ZA10205 | 200 | L.1000-P.500 | P1005 |
| ZA10106 | 100 | L.1000-P.600 | P1006 |
| ZA10206 | 200 | L.1000-P.600 | P1006 |
| ZA10108 | 100 | L.1000-P.800 | P1008 |
| ZA10208 | 200 | L.1000-P.800 | P1008 |
| ZA12105 | 100 | L.1200-P.500 | P1205 |
| ZA12205 | 200 | L.1200-P.500 | P1205 |
| ZA12106 | 100 | L.1200-P.600 | P1206 |
| ZA12206 | 200 | L.1200-P.600 | P1206 |
| ZA12108 | 100 | L.1200-P.800 | P1208 |
| ZA12208 | 200 | L.1200-P.800 | P1208 |
| ZA16105 | 100 | L.1600-P.500 | P1605 |
| ZA16205 | 200 | L.1600-P.500 | P1605 |
| ZA16106 | 100 | L.1600-P.600 | P1606 |
| ZA16206 | 200 | L.1600-P.600 | P1606 |
| ZA16108 | 100 | L.1600-P.800 | P1608 |
| ZA16208 | 200 | L.1600-P.800 | P1608 |



CAGE NUTS

Cage nuts for front insertion, available with threading M6 and M8, particularly sturdy and simple to install.

- **DGIFM6** - pack of 50 pcs M6
- **DGIFM8** - pack of 50 pcs M8



SELF-THREADING SCREWS 5.5

Particularly recommended to secure equipment in the drills \varnothing 4.6 arranged for the purpose on the frame and on the section bars.

- **VA05** - pack of 50 pcs



HOISTING STIRRUPS

Realized in zinc-coated sheet, they are recommended when coupled and pre-wired modules of considerable weight have to be hoisted, they can be used alone or combined with the hoisting bars and are available in kits of 2 and 3 pieces.

Max load hoisting stirrup can lift 600 Kg/m.

| ITEM. | FOR CABINETS WIDTH | DEPTH | KIT |
|-------|--------------------|-------|-----|
| SZ025 | 600-800-1000-1200 | 500 | 2PZ |
| SZ026 | 600-800-1000-1200 | 600 | 2PZ |
| SZ028 | 600-800-1000-1200 | 800 | 2PZ |
| SZ035 | 1600 | 500 | 3PZ |
| SZ036 | 1600 | 600 | 3PZ |
| SZ038 | 1600 | 800 | 3PZ |



HOISTING BARS

To be combined with the hoisting stirrups to handle coupled modules of fairly heavy weight. They are realized in galvanized pipe diam. 60.3. Hoisting can be done by special sliding hoisting points that permit to properly balance the weight even if unbalanced. They are supplied in pair, by the meter, complete with two hoisting points each bar.

- **BSA01**

REMARK: just for MC-CX cabinets



INNER DOORS

Manufactured in EN 1.4301 (AISI 304) s/s, finely satin-finished and protected, thickness 20/10, it is delivered in assembling kit and is used to install equipment inside the cabinets. The gap between the inner door and the door can be adjusted to two depth of 65 or 110 mm. The inner door can be right- or left-hinged. It can stand instruments up to a maximum weight of 30 Kg. Protection degree IP20 (IP54 on demand). Drillings can be made to order. For cabinets w 1200 the special upright, item kit CP1800 (for h.1800) or kit CP2000 (for h.2000) must be ordered.

| SINGLE ITEM. | SIZES | | FOR CABINET SERIES | |
|--------------|-------|------|--------------------|--------|
| | A | B | | |
| CP0616 | 490 | 1491 | L.600 | H.1600 |
| CP0618 | 490 | 1691 | L.600 | H.1800 |
| CP0620 | 490 | 1891 | L.600 | H.2000 |
| CP0816 | 690 | 1691 | L.800 | H.1600 |
| CP0818 | 690 | 1691 | L.800 | H.1800 |
| CP0820 | 690 | 1891 | L.800 | H.2000 |
| CP1018 | 890 | 1691 | L.1000 | H.1800 |
| CP1020 | 890 | 1891 | L.1000 | H.2000 |

When an inner door is assembled on any cabinet L.1200 a removable central upright must always be used:

| FOR CABINETS L 1200 | UPRIGHT REQUIRED |
|---------------------|------------------|
| MC H 1800 | MMC18 |
| MC H 2000 | MMC20 |
| CX H 1800 | MCX18 |
| CX H 2000 | MCX20 |
| CC H 1600 | MCC16 |
| CC H 1800 | MCC18 |

Also, for cabinets series CC two uprights code MLCC16 (for H.1600) or MLCC18 (for cabinets H.1800) are required

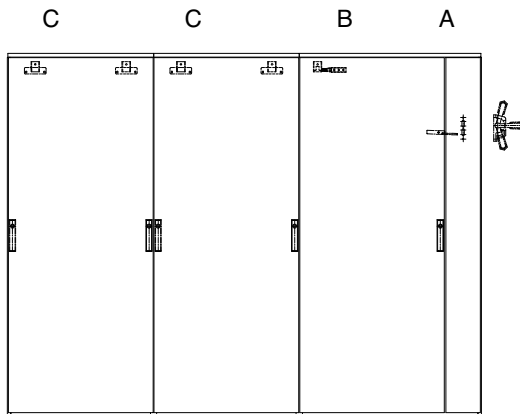

INTERLOCKS

Mechanical system that allows to establish a priority of opening of the doors for cabinets assembled in battery, it is available in three types: disconnecting switch interlock, primary interlock and secondary interlock. They have to be ordered and applied as shown on the drawing.

A) Disconnecter interlock CODE MKP.IS (Bolted panel)

B) Primary interlock CODE MKP.PR (Door with lock on the panel side or towards the cabinet outside – interlock opposite to the lock)

C) Secondary interlock CODE MKP.SE (Door with right or left lock, at choice – interlock on the same side as the lock)

REMARK: when using on the CX series, use an additional crosspiece

- **TRS06** for L.600
- **TRS08** for L.800
- **TRS10** for L.1000
- **TRS12** for L.1200



SLASH-TYPE CLOSURES

For use in place of the standard fairlead, they are highly recommended where easy cable access is desired and no special tightness is required. The skirting board is essential with this type of closure.

- **PCG0600** - for cabinets CX L.600
- **PCG0800** - for cabinets CX L.800
- **PCG1000** - for cabinets CX L.1000
- **PCG1200** - for cabinets CX L.1200

REMARK: for cabinets L.1600 no. 2 PCG0800 must be ordered



CROSS ELEMENTS FOR DOOR:

Section 20x20mm.

Available for the doors of all cabinets. Designed to be secured directly to the inner frame by self-tapping screws diam. 5.5 and by bi-adhesive tape to the door. They are the ideal fixing to secure cableways, sheaths or cables and/or to stiffen widely drilled doors

- **PRP256** - for width. 600
- **PRP258** - for width. 800
- **PRP250** - for width. 1000



HOISTING EYEBOLTS

Available both in galvanized steel and stainless steel, they are supplied in kits of 4 pieces and are recommended when single modules of limited weight have to be handled. Max hoisting load: 450 Kg for per pair of eyebolts.

- **GZ04** - Kit of no 4 eyebolts, galvanized - for cabinets L.600-800-1000-1200
- **GZ06** - Kit of no. 6 eyebolts, galvanized - for cabinets L.1600
- **G104** - Kit of no. 4 eyebolts, galvanized - for cabinets L.600-800-1000-1200
- **G106** - Kit of no. 6 eyebolts, galvanized - for cabinets L.1600



SLIDE GUIDES

Designed and manufactured to facilitate the introduction into the cabinet, through the side panel, of inner plates made of several modules, factory assembled, though of a considerable weight. The kit includes a lower guide, the sliding rollers for application to the plate, and the screws for assembling. Available in four lengths:

- **GSP06** - pair of sliding guides for cabinets L.600
- **GSP08** - pair of sliding guides for cabinets L.800
- **GSP10** - pair of sliding guides for cabinets L.1000
- **GSP12** - pair of sliding guides for cabinets L.1200

(* **REMARK:** two slide guide GS08 are required for cabinets L.1600, only for the series MC CX

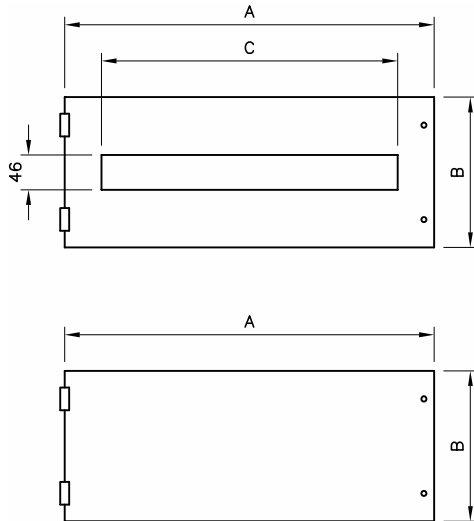

PANELS

The front panels, available in 3 heights (200, 400, and 600 mm) are hinged on one side while on the other have a screw closure. Available either drilled or solid (the latter can be drilled to drawing).

The useful compartment for panel housing is 1.600 mm. for cabinets having nominal height 1.800 mm. and 1.800 mm. for cabinet having nominal height 2.000 mm. The gap between panels and the front door can be 100 mm or 70 mm.

| ITEM. | OUT. SIZES | | | NO. OF MODULES PER PANEL | FOR FRAMES |
|----------------|------------|-----|-----|--------------------------|--------------|
| | A | B | C | | |
| PMF0620 | 480 | 200 | 396 | 22 | TM-TC L.600 |
| PMF0640 | 480 | 400 | 396 | 22 | TM-TC L.600 |
| PMF0660 | 480 | 600 | 396 | 22 | TM-TC L.600 |
| PMC0620 | 480 | 200 | | CIECO-BLIND | TM-TC L.600 |
| PMC0640 | 480 | 400 | | CIECO-BLIND | TM-TC L.600 |
| PMC0660 | 480 | 600 | | CIECO-BLIND | TM-TC L.600 |
| PMF0820 | 680 | 200 | 594 | 33 | TM-TC L.800 |
| PMF0840 | 680 | 400 | 594 | 33 | TM-TC L.800 |
| PMF0860 | 680 | 600 | 594 | 33 | TM-TC L.800 |
| PMC0820 | 680 | 200 | | CIECO-BLIND | TM-TC L.800 |
| PMC0840 | 680 | 400 | | CIECO-BLIND | TM-TC L.800 |
| PMC0860 | 680 | 600 | | CIECO-BLIND | TM-TC L.800 |
| PMF1020 | 880 | 200 | 792 | 44 | TM-TC L.1000 |
| PMF1040 | 880 | 400 | 792 | 44 | TM-TC L.1000 |
| PMF1060 | 880 | 600 | 792 | 44 | TM-TC L.1000 |
| PMC1020 | 880 | 200 | | CIECO-BLIND | TM-TC L.1000 |
| PMC1040 | 880 | 400 | | CIECO-BLIND | TM-TC L.1000 |
| PMC1040 | 880 | 600 | | CIECO-BLIND | TM-TC L.1000 |



WORK TABLETOPS

Made of AISI 304 s/s, 2B finishing; available in 3 widths and fit for being installed inside either on compact cabinets or on modular ones. To be fixed to the inner frames of the doors, they are equipped with supporting bracket

- **PL0600** for doors L.600
- **PL0800** for doors L.800
- **PL1000** for doors L.1000



IP20

SYSTEMS FOR MODULAR SWITCHES

The modular cabinets series MC/CX are particularly suitable to accommodate modular switches. This application requires the matching frame formed by 2 pre-drilled uprights with balancing panels and assembling screws.

- **TM0618:** for L. 600 H. 1800
- **TM0620:** for L. 600 H. 2000
- **TM0818:** for L. 800 H. 1800
- **TM0820:** for L. 800 H. 2000
- **TM1018:** for L. 1000 H. 1800
- **TM1020:** for L. 1000 H. 2000

When installing an inner door on any cabinet L.1200 a removable central uprights must always be used:

| FOR CABINETS L 1200 | UPRIGHT TO BE USED |
|---------------------|--------------------|
| MC H 1800 | MMC18 |
| MC H 2000 | MMC20 |
| CX H 1800 | MCX18 |
| CX H 2000 | MCX20 |



SUPPORTS WITH DIN BARS

Delivered with drilled standard panels, can be ordered separately for the assembling of special equipment or to be accommodated behind blind panels. They come complete with a pair of sturdy rests, DIN bar and corresponding bolts and screws; all EN 1.4301 (AISI 304) s/s execution.

| ITEM. | FOR COMPACT CABINET |
|--------------|---------------------|
| SDM06 | L 1200 |
| SDM08 | L 800 e L 1600 |
| SDM10 | L 1000 |

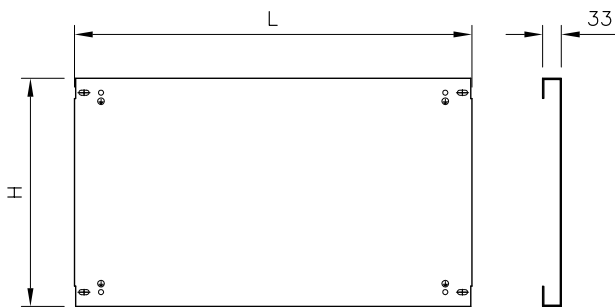

PARTIAL INNER PLATES FOR MODULAR PANELS

Partial plates for modular panels to be always combined with the plate supportingo uprights for the MC – CX series

| ITEM. | X | Y | FOR PANELS CODE |
|---------------|-----|-----|----------------------------------|
| PA0502 | 500 | 200 | PMC0620 PMF0620 |
| PA0504 | 500 | 400 | PMC0640 PMF0640 |
| PA0506 | 500 | 200 | PMC0660 PMF0660 |
| PA0702 | 700 | 200 | PMC0820 PMF0820 |
| PA0704 | 700 | 400 | PMC0840 PMF0840 |
| PA0706 | 700 | 600 | PMC0860 PMF0860 |
| PA0902 | 900 | 200 | PMC1020 PMF1020 |
| PA0904 | 900 | 400 | PMC1040 PMF1040 |
| PA0906 | 900 | 600 | PMC1060 PMF1060 |

PLATE SUPPORTING UPRIGHTS

| ITEM. | H |
|---------------|------|
| MSPA18 | 1800 |
| MSPA20 | 2000 |



RATCHET LOCK

The standard outfit for all cabinets includes the ratchet lock It. SG329.
Various optional locks are however available, all perfectly interchangeable with the standard ones, either with low-voltage or Yale key.

| ITEM. | TYPE | EXTERNAL | INSERT MATERIAL |
|-----------|---------------------------------------|------------------|-----------------|
| SG321 | “T” handle key EK333(*) | black polyamides | A.304 s/s |
| SG327 | “L” handle key EK333(*) | black polyamides | A.304 s/s |
| SG328 | rotating handle key EK333(*) | black polyamides | A.304 s/s |
| SG329(**) | box lock - twin-comb insert | black polyamides | A.304 s/s |
| SG330(**) | rotating handle with twin-comb insert | black polyamides | Stainless steel |

REMARKS:

(*) Key EK333 - Yale type - is supplied with the lock. Different key coding can be provided on request

(**) Lock item SG215S is supplied without key. Optional key, to be ordered separately: item SG205CG - not s/s.



DIAGRAM HOLDING POCKET

Delivered in assembling kit with bi-adhesive tape, available in 3 models:

- **SG109**: orange ABS, for A4 documents
- **SG108**: AISI 304 stainless steel, for A4 documents
- **SG110**: AISI 304 stainless steel, for A3 documents



FIXED LECTERN

IP66

Made of AISI 304 s/s finely satin-finished and protected, it is fitted directly to the door. Their execution and shape enable good availability of space, even in restricted space conditions. The handy lower panel also allows wiring without the need for pushbuttons, instruments or raceways to be secured to movable or removable part. The top surface is perfectly smooth and free from gaps for improved cleaning. Three lengths are available:

- **SA531** - fixed lectern L.600
- **SA532** - fixed lectern L.800
- **SA535** - fixed lectern L.1000



ANTI-CLOSING DEVICE

Made of AISI 304 stainless steel, recommended to avoid the door accidental closing. Delivered in assembling kit.

- **DAC02**



SET OF 4 CASTERS DIAM. 80 WITH S/S. SUPPORT

Grey rubber wheels, two with double-action brake. Capacity 50 kg each

- RPF080



SET OF FOOT GUARDS FOR WHEELS Ø 80

Set of 4 safety guards made of S.S. for application to wheels, to prevent accidental foot crushing.

- SP080



TAPS



The taps, without lamp, available in various versions, are to be fixed on 35mm DIN rail (to be ordered separately) and connected by screwless press-on terminals.

TECHNICAL DATA

- **Connexion:** 3 press-on terminals for flexible wire
- **Fixing:** Clip for assembling on 35mm DIN rail EN 50022
- **Housing:** UL94 V-0 plastic
- **Sizes:** 92 x 62 x 48 mm
- **Weight:** 0.20 Kg
- **Assembling position:** at customer's choice
- **Oper. Temp.:** -45°C +70°C
- **Protection degree:** IP20

| CODES | VOLTAGE | TAP | CURRENT | APPROVAL |
|-------|---------|---------------------------|---------|----------|
| PSFD | 250V AC | GERMANY | 16.0 A | |
| PSFF | 250V AC | FRANCE | 16.0 A | |
| PSFCH | 250V AC | SWITZERLAND | 10.0 A | |
| PSFGB | 250V AC | GREAT BRITAIN/ IRELAND | 13.0 A | |
| PSFUS | 125V AC | USA/CANADA | 15.0 A | c RU us |
| PSFI | 250V AC | ITALY | 16.0 A | |



LAMP

For use in control board featuring limited dimensions and high density of components, they are delivered complete with fixing stirrups and screws for easy installation anywhere inside the cabinet.

Available either without tap or with several types of taps.

TECHNICAL DATA

- **Absorbed power:** 11 W (incandescent lamp 75W)
- **Lighting power:** 900 Lm
- **Bulb:** energy-saving bulb, bulb socket 2G7 10.000 h
- **Switch:** ON/OFF switch for lighting lamps (PIR motion detector on request)
- Terminal 2,5 mm² with traction-proof device
- Max. torque 0,8 Nm
- **Fixing:** by screw, M5, distance 300 mm
- **Housing:** light grey UL94 V-D plastic
- **Sizes:** 345 x 91 x 40 mm
- **Installation:** narrow side / large side
- **Temp. Of work envir.:** -20°C +50°C (-4°F +122°F)
- Protection degree: IP20

| CODES | VOLTAGE | TAP | CURRENT | APPROVAL |
|---------|------------------|---------------------------|---------|---------------|
| LP230D | 230V AC 50/60 HZ | GERMANY | 16.0 A | VDE |
| LP230F | 230V AC 50/60 HZ | FRANCE | 16.0 A | VDE |
| LP230CH | 230V AC 50/60 HZ | SWITZERLAND | 10.0 A | VDE |
| LP230GB | 230V AC 50/60 HZ | GREAT BRITAIN/ IRELAND | 13.0 A | VDE |
| LP120US | 120V AC 50/60 HZ | USA/CANADA | 15.0 A | c RU us |
| LP230 | 230V AC 50/60 HZ | NONE | | VDE + c RU us |
| LP120 | 120V AC 50/60 HZ | NONE | | c RU us |



GARNITURE ELECTROCONDUCTRICE **emc**[®]

La garniture électroconductrice est nécessaire pour le blindage du champ électrique ou magnétique.

L'élasticité de la garniture est obtenue par l'emploi de mousses de matériaux divers: silicones, néoprènes ou epdm selon les conditions d'emploi.

- GCE